

- PLAN -
Scale 1" = 40'

Note: All 4" connecting sewers shall be constructed on an upward grade of two per cent from the main sewer, and shall extend from the main sewer to the property line.

- LEGEND -
 " or in means inch or
 ' or ft. means foot or
 M. means number
 C. means Center Line
 E. means Elevation
 St. means Street
 6" Vitrifed Pipe Sewer
 6" x 4" Wye with 4" conn.
 Manhole to be constr.
 Manhole now in shown
 6" Cast Iron Pipe sewer

SEWER DEPT.
 Lineal ft. of 6" vitrifed pipe sewer
 10' of 6" x 4" wye with 4" conn.
 10' of Manholes to be constructed
 Lineal ft. of 6" Cast Iron

TITLE TO
 Title to LUGO AVE
 in Book 2447 Official
 192, 196, 212, 215, 217, 219
 and in Book 2865
 page 481, Official
 California.

GRADE RECORD
 Grade of LUGO AVE
 2083 dated March
 California.

DATUM
 All elevations
 are above a plane
 1912 as established
 of San Bernardino

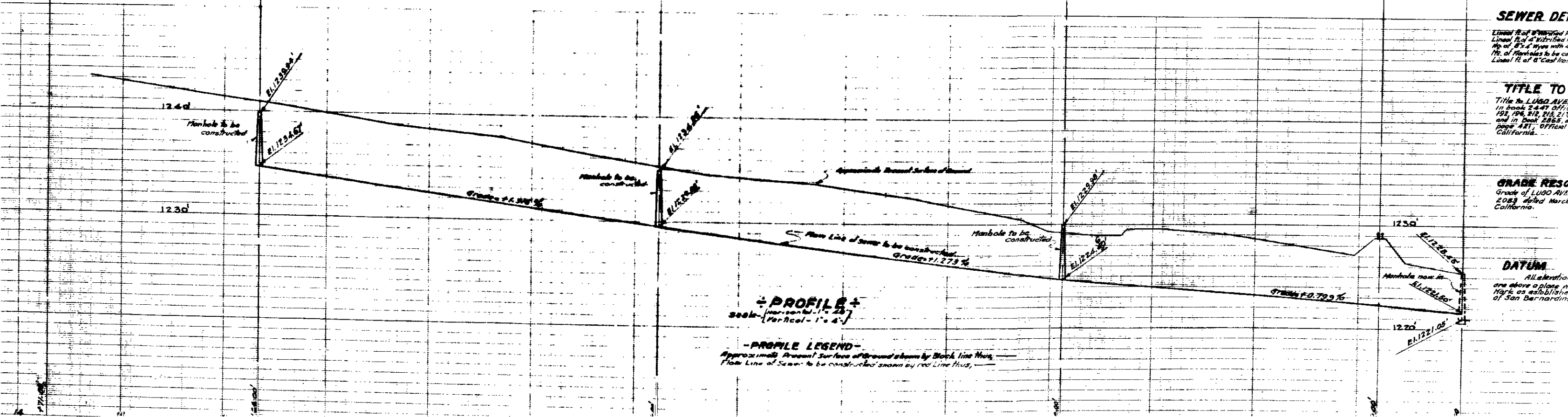

- PROFILE -
Scale (horizontal) 1" = 25'
Scale (vertical) 1" = 4'

- PROFILE LEGEND -
 Approximate Present Surface of Ground shown by Black line thus, —
 Flow Line of Sewer to be constructed shown by red line thus, —